

CATALOG

air prep

70 Series

Stainless Steel FRL Series



numatics®

Table of Contents



70, 71 & 72 Series	3-13
Features and Benefits	3
Particulate Filter	4
Coalescing Filter	5
Regulator	6-7
Particulate Filter/Regulator	8-9
Lubricator	10
Miniature Filters	11
Miniature Regulator	12
Miniature Particulate Filter/Regulator	12
Replacement and Repair Kits	13



70, 71 & 72 Series Stainless Steel Series

- Two Series Available – High Flow and Miniature
- 316 Stainless Steel Construction
- All Viton Seals
- 5 Micron Particulate
- Four Grades Coalescing
- Exceeds NACE Specifications
- High Flow in a Compact Size



70, 71 and 72 Series Stainless Steel FRL Series

NUMATICS®



ANSI SYMBOL



Stainless Steel Particulate Filter

F70B Series

- 316 Stainless Steel Body Construction
- All Seals Made of Viton®
- 5 Micron Element Standard
- Meets NACE Specifications

Specifications

Temperature Range °F (°C): 40°-180° (4°-82°)

Max. Operating Pressure PSIG (BAR): 300 (20)

Weight, lbs. (kg.): 1.88 (.85)

Element: Sintered Polypropylene

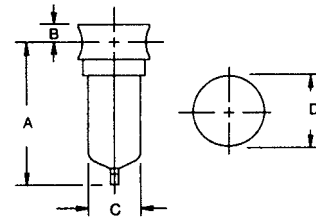

Flow Ratings (based on 100 PSI inlet)

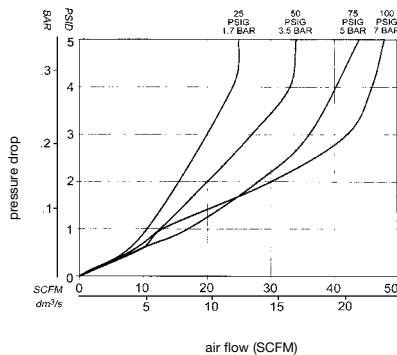

Dimensions

top dimensions = inches

bottom dimensions (in parenthesis) = millimeters

SERIES	A	B	C	D
70	5.00 (127.0)	0.56 (14.0)	1.75 (44.0)	2.38 (60.0)

How To Order

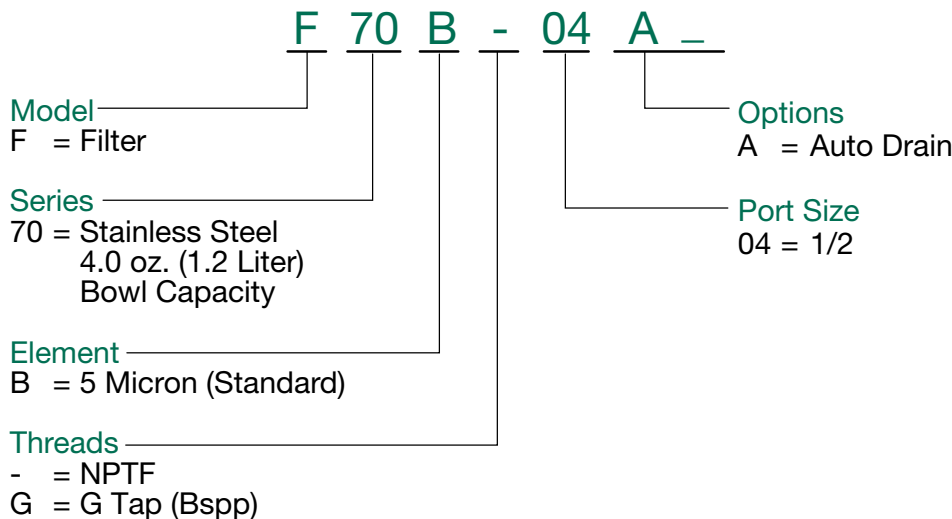

NEED MORE PARTS AND INFORMATION?

- See page 11 for information on ordering replacement parts.



ANSI SYMBOL



Stainless Steel Coalescing Filter

F70D Series

- 316 Stainless Steel Body Construction
- Complete Coalescing Filter Line
- All Seals Made of Viton®
- Meets NACE Specifications

Specifications

Temperature Range °F (°C): 40°-180° (4°-82°)

Max. Operating Pressure PSIG (BAR): 300 (20)

Weight, lbs. (kg.): 1.88 (.85)

Flow Rating (based on 100 PSI inlet)

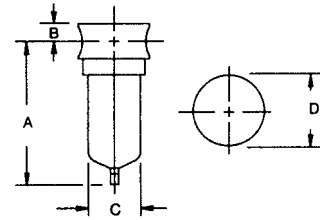
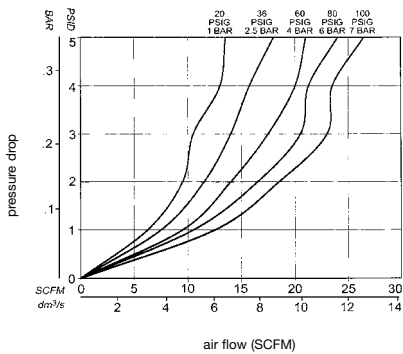

Dimensions

top dimensions = inches

bottom dimensions (in parenthesis) = millimeters

SERIES	A	B	C	D
70	5.00 (127.0)	0.56 (14.0)	1.75 (45.0)	2.38 (60.0)

How To Order

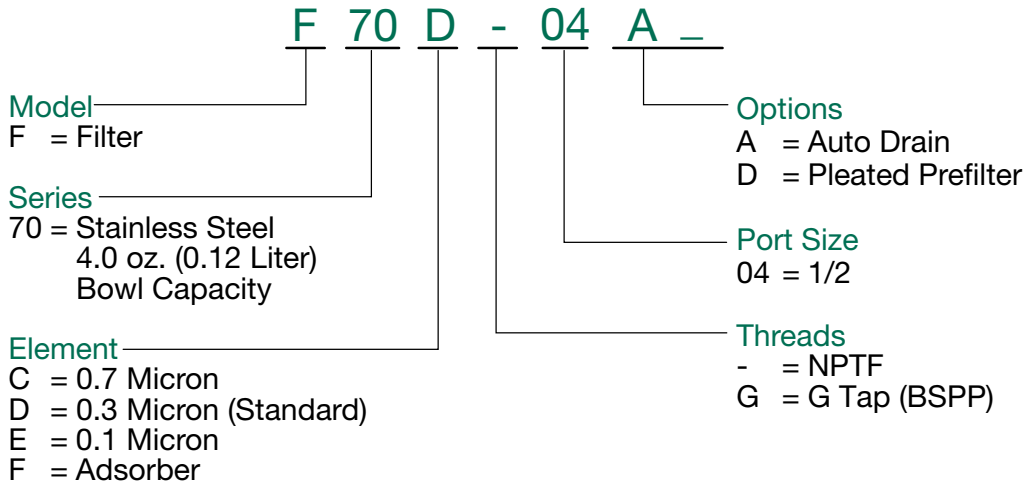

NEED MORE PARTS AND INFORMATION?

- See page 11 for information on ordering replacement parts.



70, 71 and 72 Series Stainless Steel FRL Series

NUMATICS®

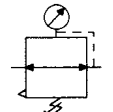

ANSI SYMBOL



Stainless Steel Regulator

R70 Series

- 316 Stainless Steel Body Construction
- All Seals Made of Viton®
- 0-125 PSI Standard
- Meets NACE Specifications

Specifications

Temperature Range °F (°C): 40° to 150° (4° to 65°)

Max. Operating Pressure PSIG (BAR): 350 (24)

Weight, lbs. (kg.): 1.79 (.81)

Flow Ratings (based on 100 PSI inlet)

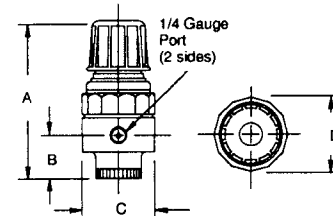
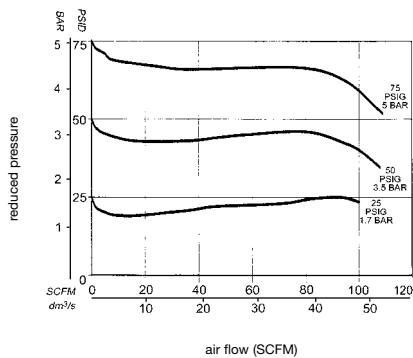

Dimensions

top dimensions = inches

bottom dimensions (in parenthesis) = millimeters

SERIES	A	B	C	D
70	4.94 (125.0)	1.38 (35.0)	2.31 (59.0)	2.44 (62.0)

How To Order

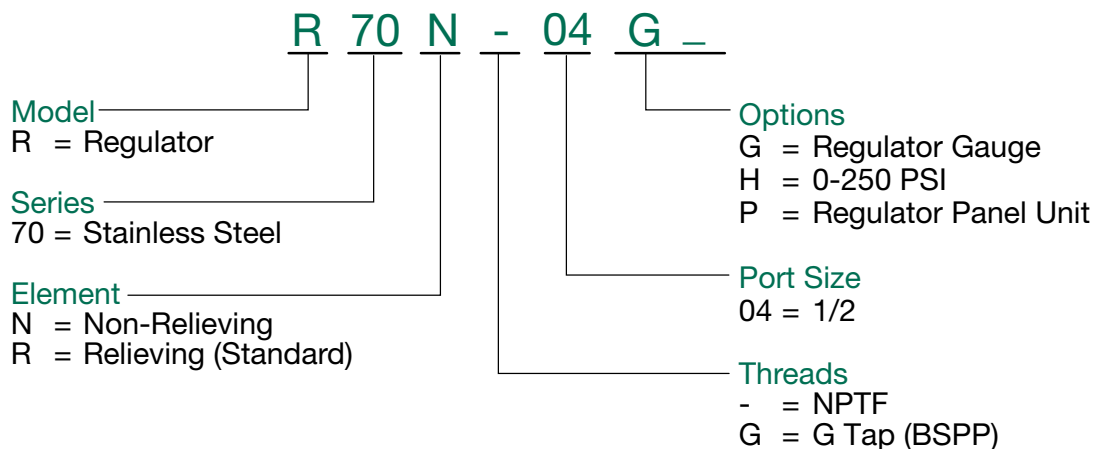

NEED MORE PARTS AND INFORMATION?

- See page 11 for information on ordering replacement parts.



Stainless Steel Regulator

R72 Series



Application

Regulators are used to reduce pressure to a required working pressure. Utilizing optimum pressure can save companies both component life and many dollars in compressed air costs. Regulators consist of a diaphragm which floats between a main spring (top) and a valve (bottom). By turning the adjustment knob clockwise, the main spring is forced onto the rubber diaphragm which, in turn, is pressed onto the valve stem. When the spring pressure becomes greater than the air pressure in the control chamber below the diaphragm, the valve is forced down and flow begins. As flow continues, the pressure begins to build and air, via the aspirator tube, fills the control chamber and forces the diaphragm upward. As forces balance, the small spring under the valve piston causes the valve to close. The cycle continues in a balanced process of reducing or increasing flow based upon the downstream pressure.

Features

- 316 stainless steel body construction
 - All seals made of Viton®
 - Standard output pressure 0-125 PSIG
 - Meets NACE specifications
- Bonnet and Knob Acetal

Specifications

Max. Pressure: 300 PSIG (20 bar)
 Temperature Range: 40° to 180° F (4° to 82° C)
 Weight: 0.55 lbs (0.24 kg)

Internal Metal Parts
 Valve - Stainless Steel
 Springs - Stainless Steel

Flow Rates

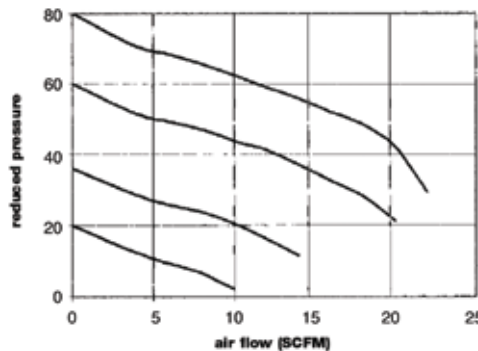

Dimensions

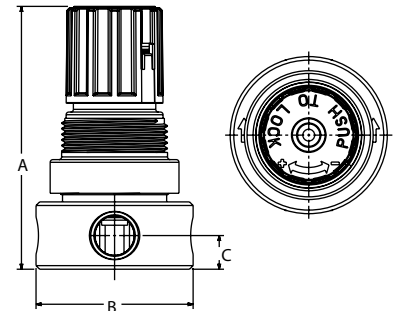

Series	A	B	C
R72	2.92	1.75	0.38

How To Order

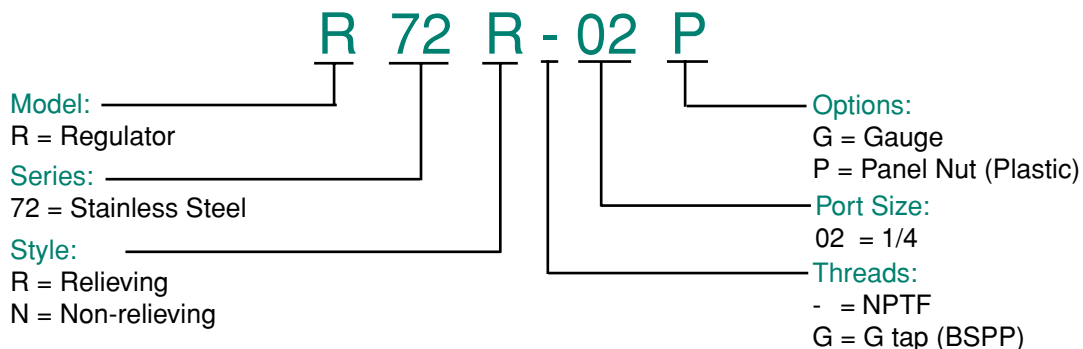



70, 71 and 72 Series Stainless Steel FRL Series

NUMATICS®

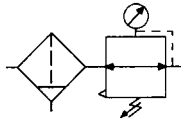

ANSI SYMBOL



Stainless Steel Particulate Filter/ Regulator

P70 Series

- 316 Stainless Steel Body Construction
- All Seals Made of Viton®
- 0-125 PSI Standard
- Meets NACE Specifications

Specifications

Temperature Range °F (°C): 40° to 180° (4° to 82°)

Max. Operating Pressure PSIG (BAR): 300 (20)

Weight, lbs. (kg.): 2.43 (1.1)

Element: Sintered Polypropylene

Flow Ratings (based on 100 PSI inlet)

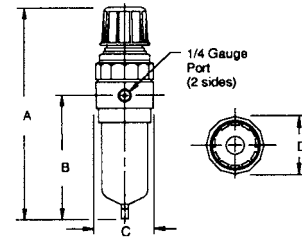
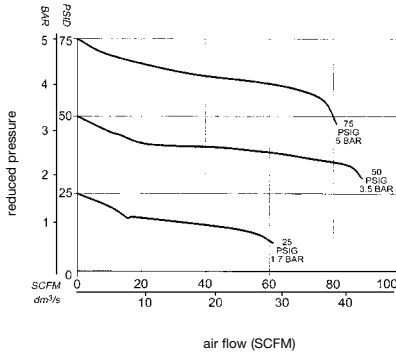

Dimensions

top dimensions = inches

bottom dimensions (in parenthesis) = millimeters

SERIES	A	B	C	D
70	8.50 (216.0)	4.94 (125.0)	2.38 (60.0)	2.44 (62.0)

How To Order

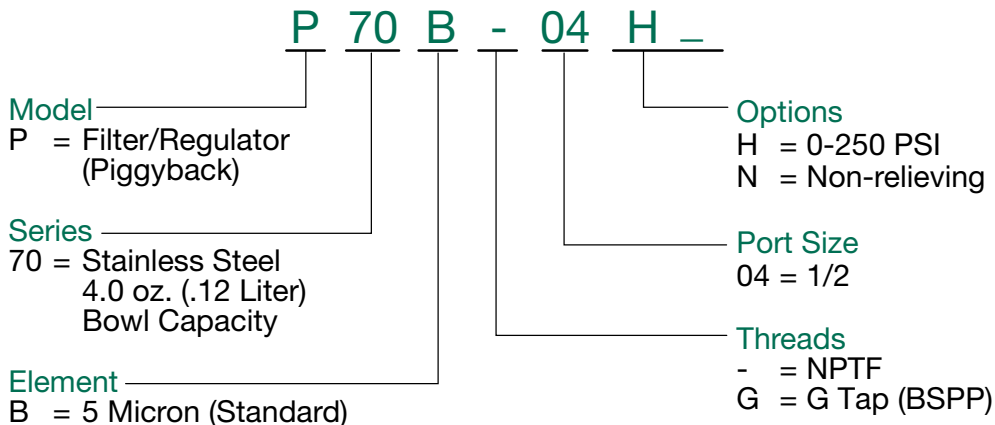

NEED MORE PARTS AND INFORMATION?

- See page 11 for information on ordering replacement parts.



Stainless Steel Particulate Filter/Regulator P72 Series

Application

The integral filter/regulator ('piggyback') is a two station component designed to filter and regulate compressed air when cost and space are of primary concern. As wet, dirty air enters, it immediately flows through the air deflector, causing the air to move in a swirling motion. After condensed water is centrifugally removed, air passes through the filter and into the regulator. The high pressure of the air is systematically reduced via the adjustment spring and valve and exits the housing as clean and dry air that is ready to work at the specified pressure.

Features

- 316 stainless steel body construction
- All seals made of Viton®
- 0-125 PSI standard
- Meets NACE specifications
- Internal plastic parts Acctal and ABS
- Element Polyethelene
- Bonnet and Knob Acctal

Specifications

Max. Pressure: 300 PSIG (20 bar)
 Temperature Range: 40° to 180° F (4° to 82° C)
 Weight: 2.43 lbs (1.1 kg)
 Element: Sintered polypropylene

Internal Metal Parts
 Valve - Stainless Steel
 Springs - Stainless Steel

Flow Rates

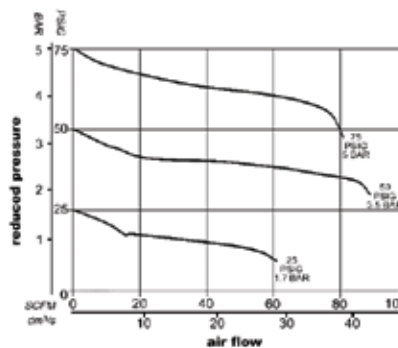

Dimensions

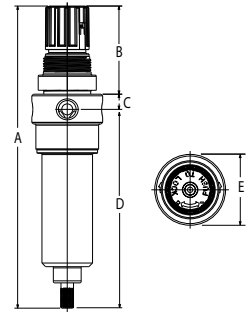

Series	A	B	C	D	E
72	7.46 (189)	2.17 (55)	.38 (10)	4.90 (124)	1.75 (44)

How To Order

P 72 B - 02 PN

Model: _____
 P = Filter/Regulator (Piggyback)

Series: _____
 72 = Stainless Steel
 4.0 oz (.12 liter) bowl capacity

Element: _____
 B = 5 micron (standard)

Options: _____
 P = Panel Nut (Plastic)
 N = Non-relieving

Port Size: _____
 02 = 1/4

Threads: _____
 - = NPTF
 G = G tap (BSPP)

Note: All BSPP (G tap) and BSPT (R tap) models use BSPT gauge threads.



70, 71 and 72 Series Stainless Steel FRL Series

NUMATICS®



ANSI SYMBOL

Stainless Steel Lubricator

L70L Series

- 316 Stainless Steel Body Construction
- All Seals Made of Viton®
- Meets NACE Specifications

Specifications

Temperature Range °F (°C): 40° to 150° (4° to 65°)

Max. Operating Pressure PSIG (BAR): 350 (24)

Weight, lbs. (kg.): 1.79 (.81)

Flow Ratings (based on 100 PSI inlet)

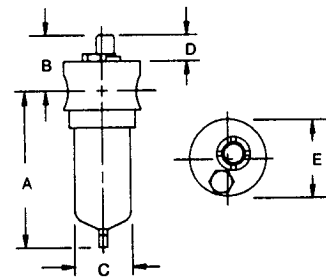
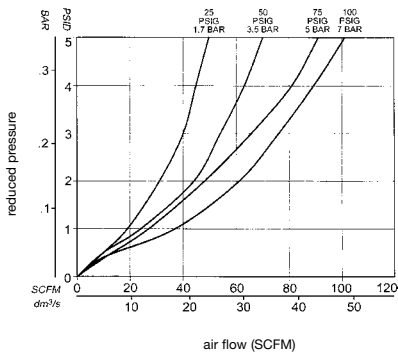

Dimensions

top dimensions = inches

bottom dimensions (in parenthesis) = millimeters

SERIES	A	B	C	D	E
70	5.00 (126.0)	1.81 (46.0)	1.75 (45.0)	0.94 (24.0)	2.38 (60.0)

How To Order

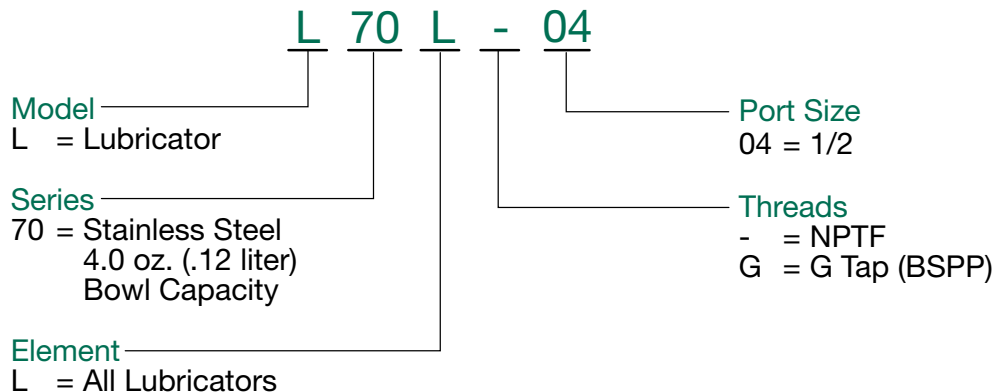

NEED MORE PARTS AND INFORMATION?

- See page 11 for information on ordering replacement parts.



Miniature Stainless Steel Particulate Filter

Specifications

Temperature Range °F (°C): 40° to 150° (4° to 65°)

Max. Operating Pressure PSIG (BAR): 350 (24)

Weight, lbs. (kg.): 1.79 (.81)

MODEL NUMBER	PIPE SIZE	MICRON RATING
F71B-02	1/4	5

Flow Ratings (based on 100 PSI inlet)

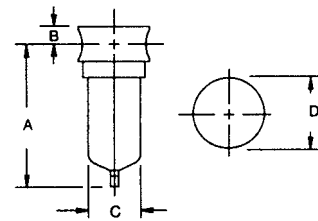
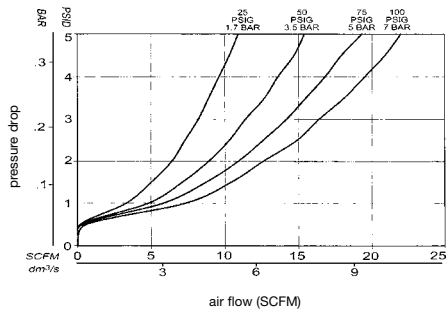

Dimensions

top dimensions = inches

bottom dimensions (in parenthesis) = millimeters

SERIES	A	B	C	D
71	3.69 (94.0)	0.37 (9.4)	1.56 (40.0)	1.56 (40.0)

Miniature Stainless Steel Coalescing Filter

Specifications

Temperature Range °F (°C): 40° to 150° (4° to 65°)

Max. Operating Pressure PSIG (BAR): 300 (20)

Weight, lbs. (kg.): 0.7 (0.31)

Element: Borosilicate Glass

MODEL NUMBER	PIPE SIZE	MICRON RATING
F71C-02	1/4	0.7
F71D-02	1/4	0.3
F71E-02	1/4	0.1
F71F-02	1/4	Adsorbing



Flow Ratings (based on 100 PSI inlet)

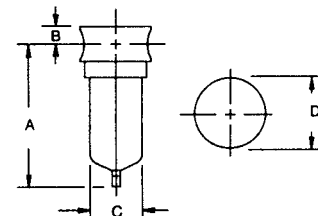
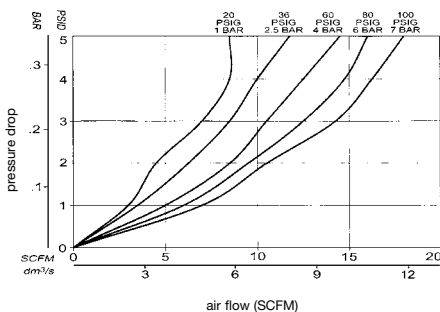

Dimensions

top dimensions = inches

bottom dimensions (in parenthesis) = millimeters

SERIES	A	B	C	D
71	3.69 (94.0)	0.37 (9.4)	1.56 (40.0)	1.56 (40.0)

NEED MORE PARTS AND INFORMATION?

- See page 11 for information on ordering replacement parts.

Information subject to change without notice. For ordering information or regarding your local sales office visit www.numatics.com.



70, 71 and 72 Series Stainless Steel FRL Series

NUMATICS®



Miniature Stainless Steel Regulator Specifications

Temperature Range °F (°C): 40° to 150° (4° to 65°)

Max. Operating Pressure PSIG (BAR): 350 (24)

Weight, lbs. (kg.): 0.5 (0.23)

MODEL NUMBER

PIPE SIZE

R71R-02

1/4

*For gauge add a "G" at the end of model number.

Flow Ratings (based on 100 PSI inlet)

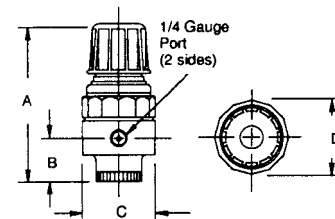
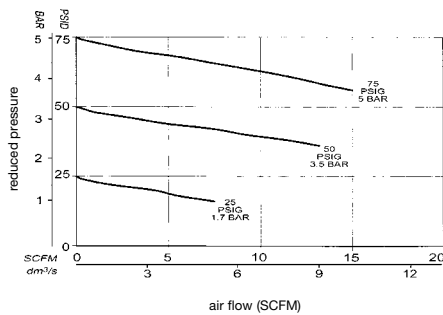

Dimensions

top dimensions = inches

bottom dimensions (in parenthesis) = millimeters

SERIES	A	B	C	D
71	2.88 (73.0)	0.50 (12.7)	1.56 (40.0)	1.56 (40.0)



Miniature Stainless Steel Particulate Filter/Regulator

Specifications

Temperature Range °F (°C): 40° to 150° (4° to 65°)

Max. Operating Pressure PSIG (BAR): 300 (20)

Weight, lbs. (kg.): 0.8 (0.37)

MODEL NUMBER

PIPE SIZE

MICRON RATING

P71B-02

1/4

5

*For gauge add a "G" at the end of model number.

Flow Ratings (based on 100 PSI inlet)

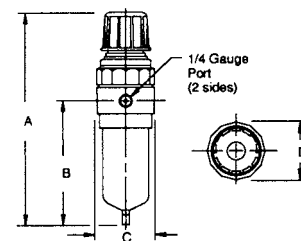
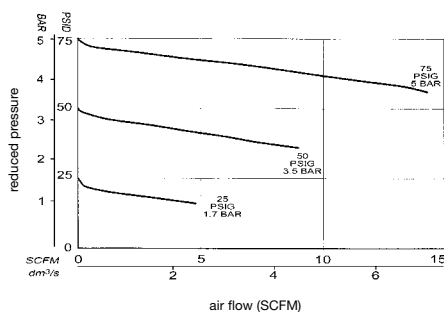

Dimensions

top dimensions = inches

bottom dimensions (in parenthesis) = millimeters

SERIES	A	B	C	D
71	6.13 (156.0)	3.75 (95.0)	1.56 (40.0)	1.56 (40.0)

NEED MORE PARTS AND INFORMATION?

• See page 11 for information on ordering replacement parts.



Replacement Kits

70 Series Stainless Steel Particulate Filter

> Element Replacement Kits

includes filter element only

kit #	description
EKF20A	70 Series, 40 micron element
EKF20B	70 Series, 5 micron element

70 Series Stainless Steel Coalescing Filter

> Element Replacement Kits

includes filter element only

kit #	description
EKF20C	70 Series, 0.7 micron element EKF20CD
EKF20CD	70 Series, 0.7 micron element with prefilter
EKF20D	70 Series, 0.3 micron element
EKF20DD	70 Series, 0.3 micron element with prefilter
EKF20E	70 Series, 0.1 micron element
EKF20ED	70 Series, 0.1 micron element with prefilter
EKF20F	70 Series, adsorbing element

70 Series Stainless Steel Regulator

> Regulator Repair Kits

kit #	description
RKC70	70 Series, cage kit (inc. adjustment knob and spring cage)
RKR70R	70 Series, (inc. relieving diaphragm and inner valve)
RKR70N	70 Series, (inc. non-relieving diaphragm and inner valve)

70 Series Stainless Steel Lubricator

> Lubricator Repair Kits

includes adjustment assembly

kit #	description
RKL70	70 Series, lubricator repair kit

71 Series Stainless Steel Particulate Filter

> Element Replacement Kits

includes filter element only

kit #	description
EKF10A	71 Series, 20 micron element
EKF10B	71 Series, 5 micron element

71 Series Stainless Steel Coalescing Filter

> Element Replacement Kits

includes filter element only

kit #	description
EKF10C	71 Series, 0.7 micron element
EKF10CD	71 Series, 0.7 micron element with prefilter
EKF10D	71 Series, 0.3 micron element
EKF10DD	71 Series, 0.3 micron element with prefilter
EKF10E	71 Series, 0.1 micron element
EKF10ED	71 Series, 0.1 micron element with prefilter
EKF10F	71 Series, adsorbing element

71 Series Stainless Steel Regulator

> Regulator Repair Kits

includes diaphragm and inner valve

kit #	description
RKR71R	71 Series, regulator repair kit (relieving)
RKR70N	71 Series, regulator repair kit (non-relieving)

NUMATICS

*World Class Supplier
of Pneumatic Components*

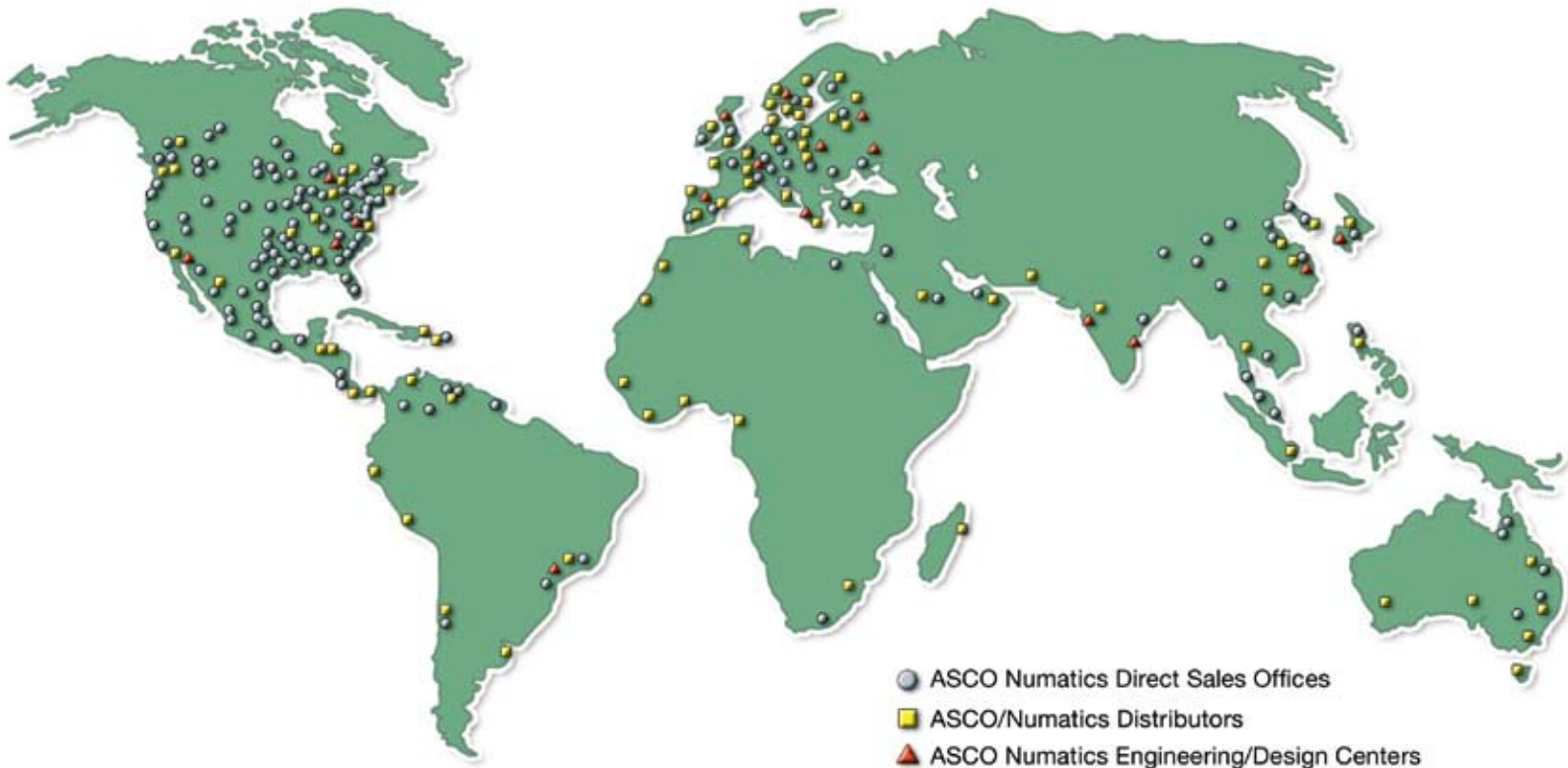

WORLD HEADQUARTERS

USA

Numatics, Incorporated

46280 Dylan Drive
Novi, Michigan 48377

P: 1-888-Numatics
1-888-686-2842

Canada

Numatics, Ltd

P: 519-452-1777

Mexico

Numatics de Mexico S.A. de C.V.

P: 52-222-284-6176

For a comprehensive listing of all Numatics production and distribution facilities worldwide, visit:

www.numatics.com