



1450 N. Milford Road, Highland, MI 48357-4560 • Phone: 248-887-4111 • Fax: 248-887-4768 xwww.numatics.com

Date: May 28, 2003 Number: RPGB-0004

To: All Numatics Offices, Distributors and Sales Personnel

From: Numatics Rodless Group

Product: G Series Adjustable Stroke Kit Bulletin

Numatics is pleased to announce the release of the Stroke Adjustment Kits for the G Series Rodless Cylinders. Application of this kit will enable field adjustment of stroke length.

### Installation

The G Series stroke adjustment kit is a two piece assembly that mounts onto the bearing rail. To install, loosen the position locking screw and slide onto the bearing rail. Once it is in the position to achieve the desired stroke length, tighten the locking screw.

**Note:** The stroke adjustment kit must always incorporate a shock absorber.

It is necessary to add 1 inch to the stroke of the cylinder for each stroke adjustment kit.

### Model Number Selection Chart

Bore	Kit Only	Kit with	Kit with	Kit with
		Standard Duty Shock	Medium Duty Shock	Heavy Duty Shock
25mm	NR015025	NR115025	NR215025	NR315025
32mm	NR015032	NR115032	NR215032	NR315032
40mm	NR015040	NR115040	NR215040	NR315040
50mm	NR015050	NR115050	NR215050	NR315050

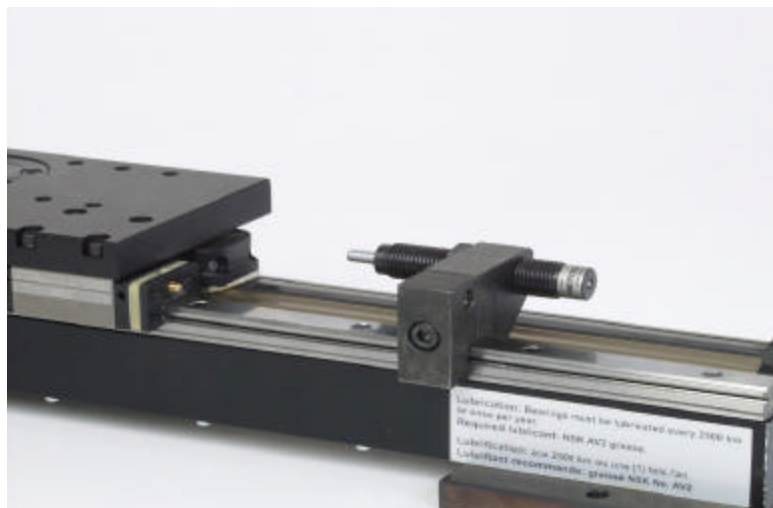

P  
R  
O  
D  
U  
C  
T  
B  
U  
L  
L  
E  
T  
I  
N



**Dimensional Information**

**G Series with Stroke Adjust Bracket**

Kit #	BORE	"W"	"W1"	"W2"	"W3"	"W4"	"H1"	"H2"	SHOCK HOLE THREAD SIZE	POSITIVE STOP HOLE THREAD SIZE	ENERTROLS METRIC SHOCK SERIES	"SL"
NR015025	G125	.75 (19.0)	5.12 (130.0)	N/A	3.94 (100.0)	.08 (2.0)	3.24 (82.3)	N/A	M14 X 1.5	M8 X 1.25	150	2.95 (75.0)
	G225	.75 (19.0)	5.51 (140.0)	.24 (6.1)	5.83 (148.0)	.08 (2.0)	3.24 (82.3)	N/A	M14 X 1.5	M8 X 1.25	150	2.95 (75.0)
NR015032	G132	.75 (19.0)	5.12 (130.0)	N/A	4.53 (115.0)	.08 (2.0)	3.54 (90.5)	N/A	M14 X 1.5	M8 X 1.25	150	2.95 (75.0)
	G232	.75 (19.0)	5.51 (140.0)	.24 (6.1)	5.83 (148.0)	.08 (2.0)	3.54 (90.5)	N/A	M14 X 1.5	M8 X 1.25	150	2.95 (75.0)
NR015040	G140	1.00 (25.4)	6.59 (167.5)	N/A	4.92 (125.0)	N/A	4.55 (115.5)	.21 (5.3)	M20 X 1.5	M8 X 1.25	225	3.03 (77.0)
	G240	1.00 (25.4)	8.46 (215.0)	N/A	8.46 (215.0)	.11 (2.7)	4.55 (115.5)	.21 (5.3)	M20 X 1.5	M8 X 1.25	225	3.03 (77.0)
NR015050	G150	1.00 (25.4)	6.59 (167.5)	N/A	4.92 (125.0)	N/A	5.36 (136.2)	N/A	M25 X 1.5	M8 X 1.25	600	4.90 (124.5)
	G250	1.00 (25.4)	8.46 (215.0)	N/A	8.46 (215.0)	N/A	5.36 (136.2)	N/A	M25 X 1.5	M8 X 1.25	600	4.90 (124.5)

\* DIMENSIONS ARE IN INCH AND (MM)

G1 Series

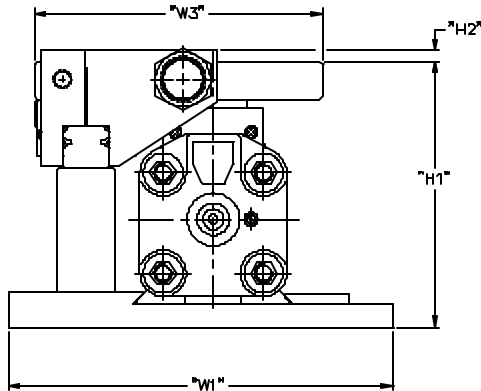

G2 Series

